

## FULL CONE NOZZLES

## CAS

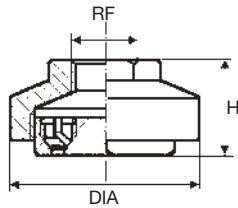

## CLUSTER NOZZLE/STANDARD SPRAY

CAS multiple full cone nozzles can produce very fine droplets using only hydraulic pressure.

Their full cone spray pattern results from the interaction of several hollow cone sprays, whose number (NR) is stated in the capacity table below.

Since the droplet size depends among other factors upon the nozzle size, these multi-orifice nozzles produce a finer spray than a standard full cone single-orifice nozzle working at the same pressure and delivering the same quantity of liquid.

Materials            B3    AISI 316 Stainless steel on request  
                              T1    Brass

70°	Code	RF inch	D mm	D1 mm	Capacity at different pressure values						Dimensions mm			
					0.7	1.0	1.5	2.0	3.0	5.0	10	NR	DIA	H
70°	CAS 1153 xx	1/2	0.9	0.5			1.08	1.25	1.53	1.98	2.79	7	50	33.5
	CAS 1274 xx		1.8	0.5			1.94	2.24	2.74	3.54	5.00			
	CAS 1343 xx	3/4	1.1	1.0	1.66	1.98	2.43	2.80	3.43	4.43	6.26	7	72	43
	CAS 1551 xx		1.5	1.4	2.66	3.18	3.90	4.50	5.51	7.11	10.1			
	CAS 1870 xx		2.1	2.0	4.20	5.02	6.15	7.10	8.70	11.2	15.9			
	CAS 2116 xx		2.5	2.0	5.60	6.70	8.20	9.47	11.6	15.0	21.2			
	CAS 2145 xx		3.0	2.0	7.00	8.37	10.2	11.8	14.5	18.7	26.5			
	CAS 2184 xx		3.5	2.0	8.89	10.6	13.0	15.0	18.4	23.8	33.6			
	CAS 2220 xx		4.0	2.0	10.6	12.7	15.6	18.0	22.0	28.4	40.2			
	CAS 2342 xx		3.5	*2.0	16.5	19.8	24.3	28.0	34.3	44.3	62.6			
	CAS 2434 xx		4.0	*2.0	21.0	25.1	30.7	35.4	43.4	56.0	79.2			
	CAS 2551 xx		5.0	*2.0	26.6	31.8	39.0	45.0	55.1	71.1	101			
	CAS 2728 xx		6.0	*2.0	35.2	42.0	51.5	59.4	72.8	94.0	133			
	CAS 2385 xx		1	5.0	2.5	18.5	22.2	27.2	31.4	38.5	49.7			
CAS 2489 xx	6.5	2.5		23.6	28.2	34.5	39.9	48.9	63.1	89.2				
CAS 2685 xx	8.0	2.5		33.1	39.6	48.4	56.0	68.5	88.5	125				
CAS 3130 xx	2	9.0	5.0	62.8	75.1	91.8	106	130	168	237	7	185	103	
CAS 3184 xx		12.0	5.0	88.9	106	130	150	184	237	336				
CAS 3245 xx		15.0	5.0	118	141	173	200	245	316	447				

\* Double capacity insert

## FULL CONE NOZZLES

CAY

## CLUSTER NOZZLE / WIDE ANGLE SPRAY

CAY multiple full cone nozzles can produce very fine droplets using only hydraulic pressure.

Their full cone spray pattern results from the interaction of several hollow cone sprays, whose number (NR) is stated in the capacity table below.

Since the droplet size depends among other factors upon the nozzle size, these multi-orifice nozzles produce a finer spray than a standard full cone single-orifice nozzle working at the same pressure and delivering the same quantity of liquid. The design of CAY nozzle bodies produces a wide angle spray while maintaining the fine droplet dimensions.

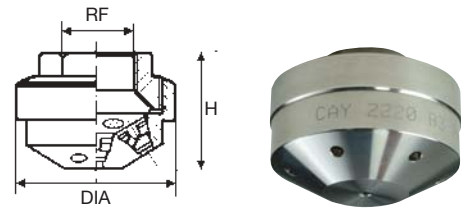

Materials	B1	AISI 303 Stainless steel
	B3	AISI 316 Stainless steel on request
	T1	Brass

130°	Code	RF inch	D mm	D1 mm	Capacity at different pressure values							Dimensions mm		
					0.7	1.0	1.5	2.0	3.0	5.0	10	(lpm) (bar)	NR	DIA
130°	CAY 1153 xx	1/2	1.0	0.5			1.08	1.25	1.53	1.98	2.79	7	40	33.5
	CAY 1274 xx		1.8	0.5			1.94	2.24	2.74	3.54	5.00			
	CAY 1343 xx	3/4	1.0	1.0	1.66	1.98	2.43	2.80	3.43	4.43	6.26	7	63	46
	CAY 1551 xx		1.4	1.4	2.66	3.18	3.90	4.50	5.51	7.11	10.1			
	CAY 1870 xx		2.0	2.0	4.20	5.02	6.15	7.10	8.70	11.2	15.9			
	CAY 2116 xx		2.5	2.0	5.60	6.70	8.20	9.47	11.6	15.0	21.2			
	CAY 2145 xx		3.0	2.0	7.00	8.37	10.2	11.8	14.5	18.7	26.5			
	CAY 2184 xx		3.5	2.0	8.89	10.6	13.0	15.0	18.4	23.8	33.6			
	CAY 2220 xx		4.0	2.0	10.6	12.7	15.6	18.0	22.0	28.4	40.2			
	CAY 2342 xx		3.5	*1.7	16.6	19.8	24.3	28.0	34.2	44.3	62.6			
	CAY 2434 xx		4.0	*1.7	21.0	25.1	30.7	35.4	43.4	56.0	79.2			
	CAY 2551 xx		5.0	*1.7	26.6	31.8	39.0	45.0	55.1	71.1	101			
	CAY 2728 xx	6.0	*1.7	35.2	42.0	51.5	59.4	72.8	94.0	133				
	CAY 2385 xx	1	5.0	3.2	18.6	22.2	27.2	31.4	38.5	49.7	70.3	7	120	81
	CAY 2489 xx		6.0	3.6	23.7	28.3	34.6	40.0	49.0	63.3	89.5			
	CAY 2685 xx		8.0	3.6	33.1	39.5	48.4	55.9	68.5	88.4	125			
	CAY 2979 xx		6.0	*2.5	47.3	56.5	69.2	79.9	97.9	126	179			
	CAY 3137 xx		8.0	*2.5	66.2	79.1	96.9	112	137	177	250			
	CAY 3130 xx	2	9.0	3.2	62.8	75.1	91.9	106	130	168	237	7	155	104.5
	CAY 3184 xx		12.0	3.2	88.9	106	130	150	184	238	336			
CAY 3245 xx	15.0		3.6	118	141	173	200	245	316	447				
CAY 3260 xx	9.0		*3.0	126	150	184	212	260	336	475				
CAY 3367 xx	12.0		*3.0	177	212	260	300	367	474	670				
CAY 3490 xx	15.0		*3.0	237	283	346	400	490	633	895				

\* Double capacity insert